

S. Carolina. Pursuant to a warrant from John Thomas Esq. Commissioner of locations in Washington District dated the 24 day of August 1773 I have a measured and laid out unto Robt. Middleton a tract of land in said District containing one thousand acres lying on a branch of Saluda River Greenville County and hath such shapes & marks cuttings & bounding as the above Plat represents. Surveyed this 29 day of August 1773 By Tho. Kepton Esq.

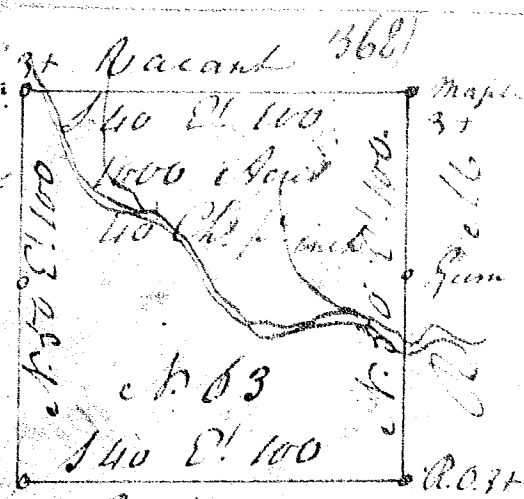

S. Carolina. Pursuant to a warrant from John Thomas Esq. Commissioner of locations in Washington District dated the 24 day of August 1773 I have a measured and laid out unto Robt. Middleton a tract of land in said District containing one thousand acres lying on a branch of Saluda River Greenville County and hath such shapes & marks cuttings and bounding as the above Plat represents. Surveyed this 29 day of August 1773 By Tho. Kepton Esq.

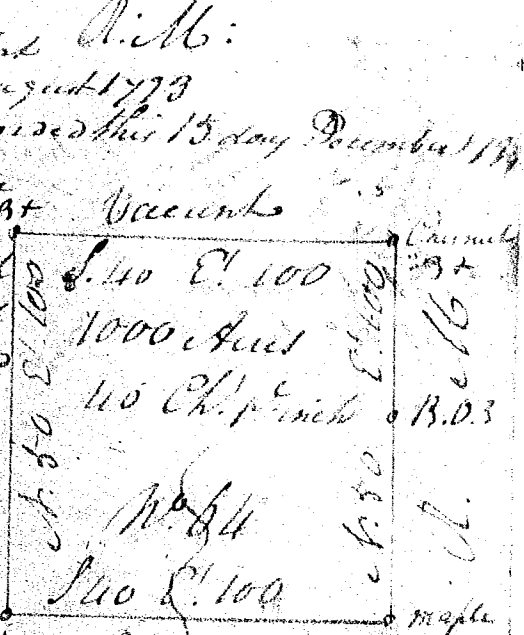

S. Carolina. Pursuant to a warrant from John Thomas Esq. Commissioner of locations in Washington District dated the 24 day of August 1773 I have a measured and laid out unto Robt. Middleton a tract of land in said District containing one thousand acres lying on a branch of Saluda River Greenville County and hath such shapes and marks cuttings & bounding as the above Plat represents. Surveyed this 29 day of August 1773 By Tho. Kepton Esq.

